

# LESSON PLAN

**Lesson Title:** The Art of Cartography  
**Grade Level:** Adaptable 3rd – 12th grades  
**Length of Lesson:** 3 45-minute class periods

**Task Description:**

Students will study a specific area to map (Region, Town, Neighborhood, etc) and create a detailed map using Elements of Art and Principles of Design.

**Instructional Objectives:**

Students will create a detailed map using the Elements of Art: line, shape, color, and texture, and the Principles of Design: Emphasis and Proportion.

**Vocabulary:**

Line	Texture	Cartography
Shape	Emphasis	Key/Legend
Color	Proportion	Compass Rose

**Museum Connections:**

John Lemmon Map, Pee Dee History Gallery

**Materials:**

Paper	Black Sharpie Marker
Pencil	Colored Pencils, Crayons, Markers or Paint
Ruler	Textural Objects (Sand or Sandpaper, fabric, Ribbon, etc)
Scissors	State and Local Maps for Reference
Glue	Creatively rendered map Key and Compass Rose examples

**Questioning:**

- Cartography is the study and practice of making maps. For thousands of years humans have made maps to help them understand the world around them. Take a look at a map of our state. What are some features that help you understand the map?
  - Key (or Legend), Compass Rose
- Does the map of the Florence Stockade drawn by John Lemmon have these features? How might that make it difficult for a person unfamiliar with the area to understand the map?
- What features can you see on the map drawn by John Lemmon?
  - Rivers and streams, railroads, Soldiers camps, boundary walls of the stockade, outer fortifications, fort, swamp
- How do maps affect our daily lives?
- How can a map be viewed as a work of art?
  - Discuss Elements of Art and Principles of Design

**Instructional Procedures:**

Preparation:

- Decide on a specific area that students should use for their map. Will they create a map of South Carolina, the Pee Dee Region, Florence County, municipality, town, community, neighborhood or school?
- Collect reference maps for student use along with examples of artistically rendered of map Keys/ Legends and Compass rose.

Process:

- Using reference maps, Students draw the outline of the specified area in pencil followed by black sharpie marker. Talk to students about accurate proportion and line.
- Students add a map Key/Legend and a Compass Rose. Encourage artistic expression in these map features.
- Students add major geographical features (rivers, swamps, bays, natural landmarks, etc.) to map consistent with the Key/Legend. Consider using textured materials to portray these features.
- Students add man-made features to map (roads, railroads, significant buildings, historic sites, etc.) Carefully consider proportion of man-made features to geographical features.
- Add color, texture and text labels, when appropriate to emphasize important map features. Make sure to title the Map!
- What other features could be added to the map? State or Local Symbols of significance? Plant or Animal life? Areas in which the student has traveled? Areas of personal significance to the student? Encourage personalization and creativity!

Conclusion:

- How does your map use the Elements of Art and Principles of Design?



Florence County Museum  
111 West Cheves Street  
Florence, SC 29501



# PEE DEE CONNECTIONS

Published by the Florence County Museum  
with funding provided by the National Endowment for the Arts

Vol. 2 No. 5



## ABOUT THIS POSTER

JOHN G. LEMMON (1832 - 1908)

During the last months of the American Civil War, the Confederate Army constructed a large outdoor prison for captured Union soldiers.

One of those soldiers was 32 year old, John G. Lemmon, of Company E, 4th Regiment, Michigan Cavalry.

Lemmon was captured near Atlanta by the Confederacy in August of 1864 and held at the infamous Andersonville Prison in Georgia before being sent to the stockade at Florence, where he was held in captivity for six months.

Lemmon served as California's State Botanist from 1888 to 1892. The herbarium he started with his wife is now part of the science department at UC Berkeley.

The Community Arts Program is part of an arts integration program through the Florence County Museum. Funding for this program is provided by the **National Endowment for the Arts** and the **Trustees of the Florence Museum**.



Florence County Museum | 111 West Cheves Street | Florence, South Carolina | 843.676.1200 | flocomuseum.org

Tuesday - Saturday: 10:00 am - 5:00 pm, Sunday: 2:00 pm - 5:00 pm

# Florence Prison & Vicinity.

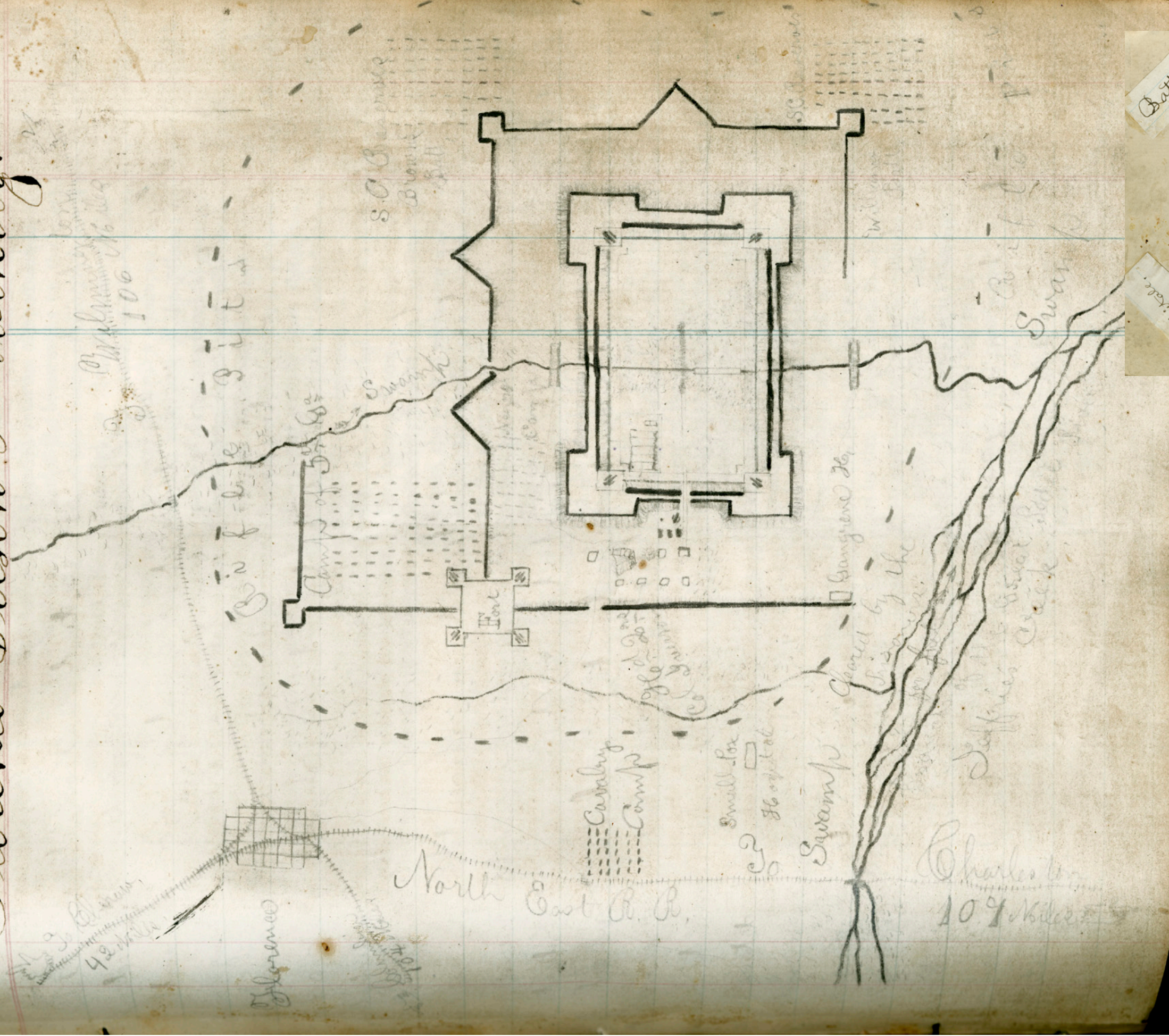

Above:  
Map of the Florence Stockade, drawn by John Lemmon. This is perhaps the most detailed map of the prison and vicinity currently known to exist. By comparing this image to other maps and descriptions, historians can have a more accurate understanding of Florence's role in the American Civil War.



Right:  
John G. Lemmon, as he appeared in 1865. At the time of his release from the Florence Stockade, Lemmon weighed only 85 pounds.